

**Modular Chandelier 2
lamps Tubes 08 x 08 -2**



Technical data

BRANCHING LINEAR TUBE

modular system of metal parts that support adjustable glass tubes or Acrylic tubes using machine-made metal parts. The Branches are made of Hi-Grade steel, sand blasted and electroplated or Powder coated SUSPENSION Ships with 1000mm stem. Please inquire about custom stem. CANOPY 100mm round canopy hunged straight.

Lighting Area 1-2 square meters

Optics 180°

input voltage AC85-265V

LED power 2 X 4W G9

Total Lumens 600lm±5%

LED source Osram LED ≥70lm per watt

Color temperature 3000K.

Lifespan ≥25000h

Working temperature -30°~50°C

IP20 Protection Class II CE

Material Machined Aluminum Glass White Tube

Finishes Black Bronze Polished Nickel Brushed Brass

Make Lumeplus Tubes 08 x08 -2

TOP

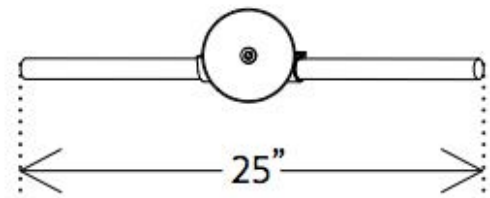

FRONT

SIDE

